

**STRAIGHT JACK RECEPTACLE FOR PCB  
SOLDER LEGS - PACK. 100**

**R110.426.097**

**SERIES**

**MMCX**

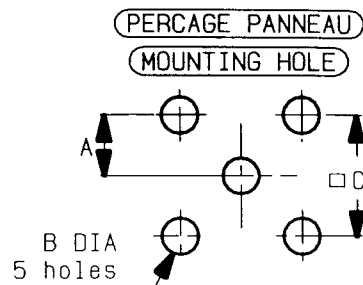
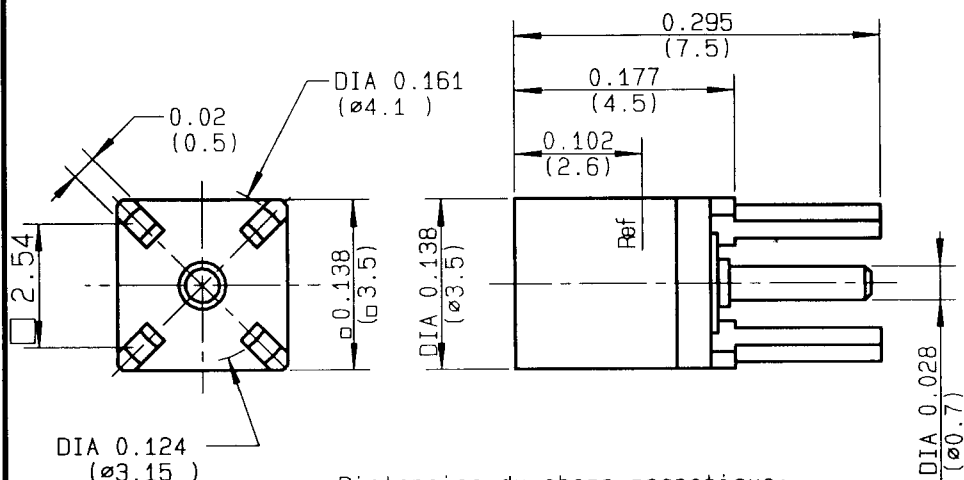

	MM		INCH	
	maxi	mini	maxi	mini
A	1.29	1.25	0.051	0.05
B	0.85	0.75	0.033	0.03
C	2.56	2.52	0.101	0.099

Distorsion du champ magnetique:  
(Distorsion of the magnetic field)  
≤ 0.5 ppm at 10mm at Bo=1.5 Tesla

NOMINAL IMPEDANCE	<b>50</b> Ω
FREQUENCY RANGE	<b>0-6</b> GHz
TEMPERATURE RATING	<b>-55/+155</b> °C
V.S.W.R	<b>NA</b> + x F(GHz)Maxi
RF INSERTION LOSS	<b>NA</b> √F(GHz) dB Maxi
VOLTAGE RATING	<b>170</b> Veff Maxi
DIELECTRIC WITHSTANDING VOLTAGE	<b>250</b> Veff Mini
INSULATION RESISTANCE	<b>1000</b> MΩMini
HERMETIC SEAL	<b>NA</b> Atm.cm <sup>3</sup> /s
LEAKAGE (pressurized only)	<b>NA</b>
MECHANICAL DURABILITY	<b>500</b> Cycles
WEIGHT	<b>.25</b> gr
SPECIFICATION	<b>NON MAGNETIC COMPONENT PHILIPS XJR 140-6810</b>

CABLES :	
OTHERS CHARACTERISTICS	
CABLE RETENTION	<b>NA</b> N Mini
CENTER CONTACT RETENTION	
Axial force - mating end	<b>5</b> N Mini
Axial force - opposite end	<b>5</b> N Mini
Torque	<b>NA</b> cm.N Mini
RECOMMENDED TORQUES	
Mating	<b>NA</b> cm.N
Panel nut	<b>NA</b> cm.N
Clamp nut	<b>NA</b> cm.N

CONNECTOR PARTS:	MATERIALS	FINISH	(all values are given in micrometers)
BODY	BERYLLIUM COPPER	GBR 2	
OUTER CONTACT			
CENTER CONTACT	BERYLLIUM COPPER	GOLD 1.3 OVER COPPER 2.5	
INSULATOR	PTFE	-	
GASKET		-	
OTHERS PIECES			

ISSUE	CREATION DATE	FILE PART-NUMBER
<b>0128C00</b>	<b>28/08/1996</b>	<b>96-0103-512</b>



FANJAT

The information given here is subject to change without notice.  
Design changes may be in order to improve the product.

*Connect to the future*